

Gare Maritiem



Rue Picard 7



Hôtel de la Poste

Entrée / Ingang



Picardstraat 3

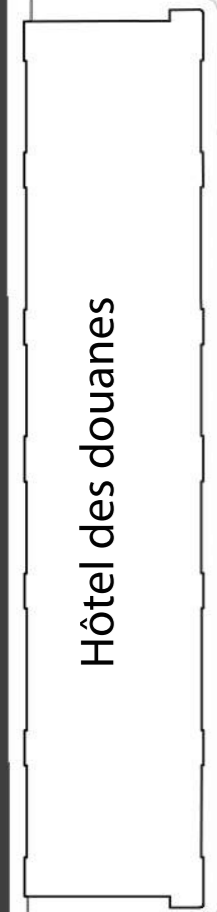

Hôtel des douanes

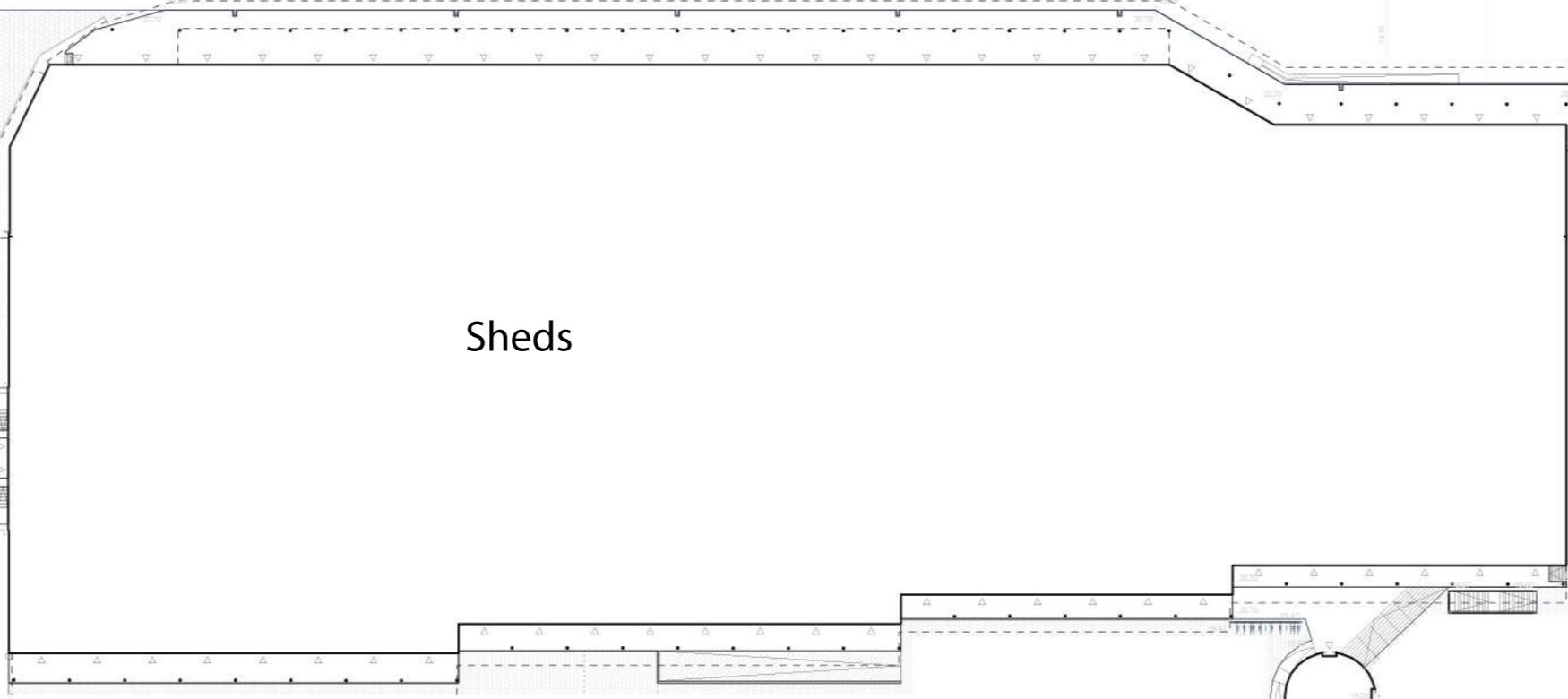

Sheds

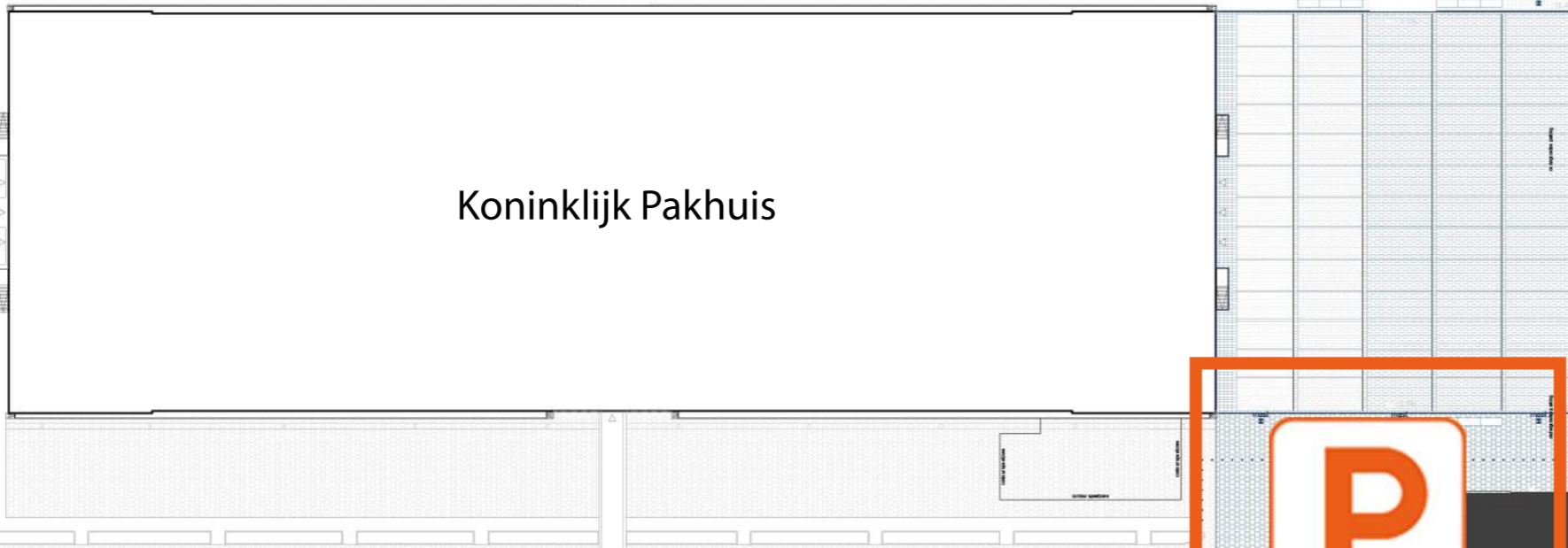

Koninklijk Pakhuis

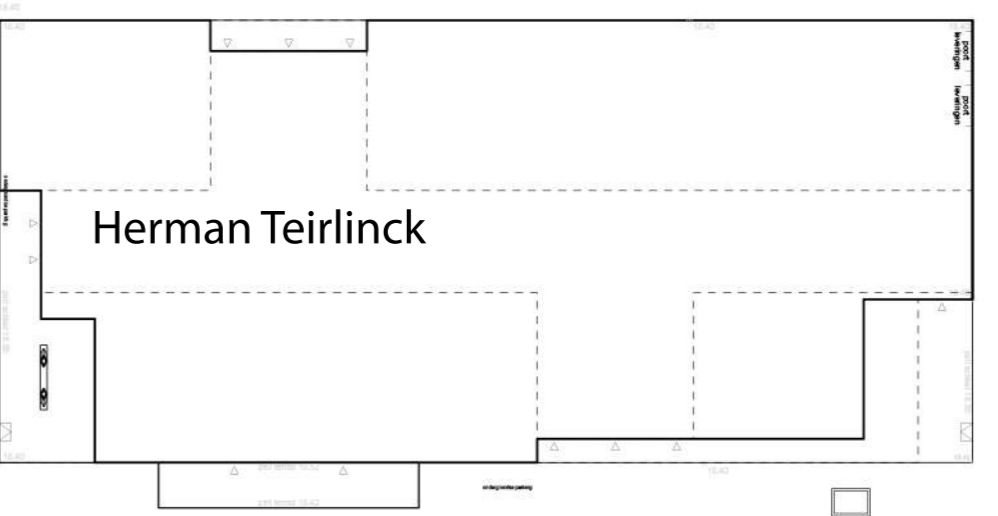
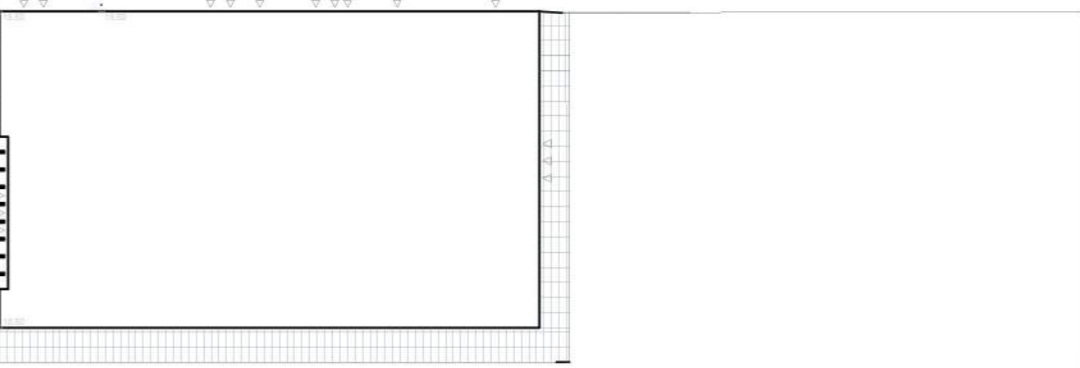
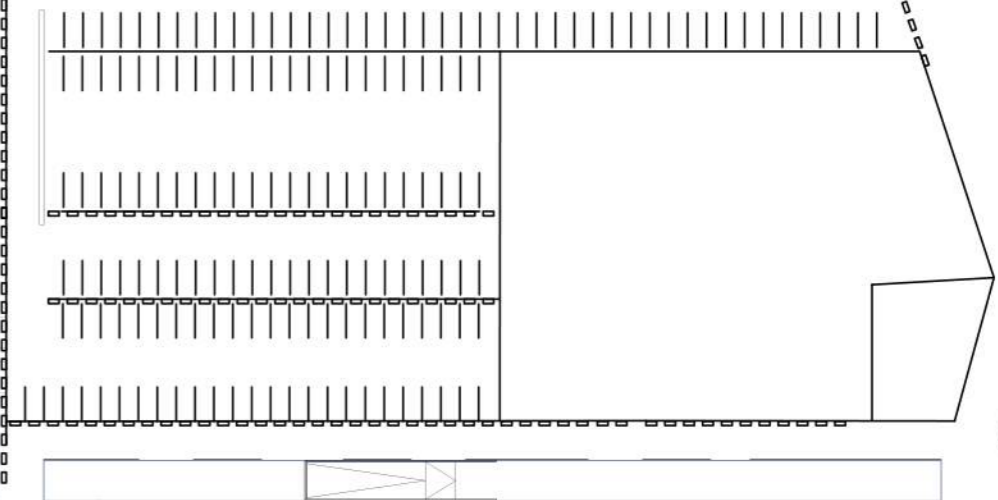
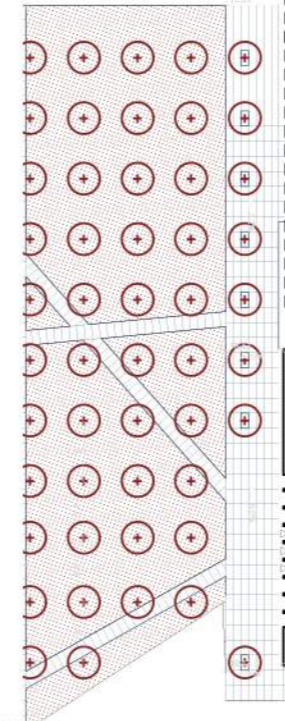

Herman Teirlinck

Rue Picard 1

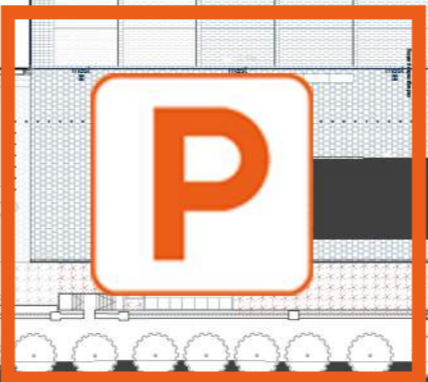

P

i

Havenlaan

Avenue du port Havenlaan 86 C



Avenue du port

Havenlaan 88